

RIG LAYOUT

WOLF CREEK #71-D3

SE1/4SW1/4 SECTION 36, TOWNSHIP 8 SOUTH,
 RANGE 90 WEST OF THE 6TH P.M.
 COUNTY OF PITKIN, STATE OF COLORADO

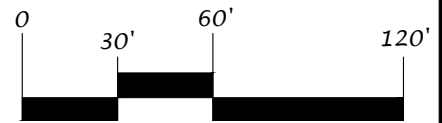
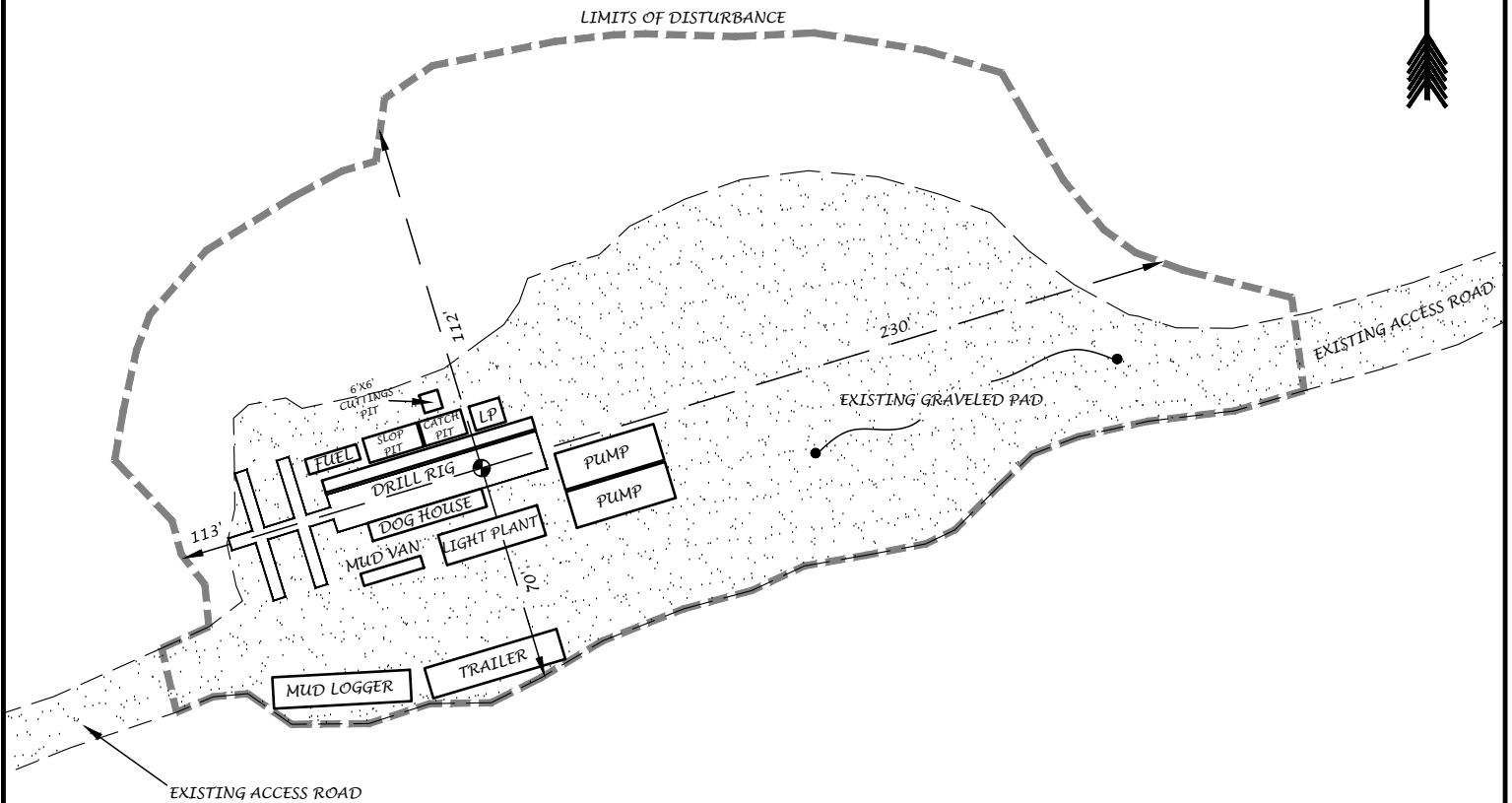

SCALE: 1" = 60'

TRUE NORTH
 COLORADO
 A LAND SURVEYING AND MAPPING COMPANY

BLACK HILLS ENERGY
 SECTION 36, TOWNSHIP 8 SOUTH, RANGE 90 WEST OF 6TH P.M.
 COUNTY OF PITKIN, STATE OF COLORADO



TRUE NORTH COLORADO, LLC.
 A LAND SURVEYING AND MAPPING COMPANY
 1118 BENNETT AVENUE
 GLENWOOD SPRINGS, COLORADO 81601
 (970) 945-1105
 www.truenorthcolorado.com

PROJECT NO: 2017-216	DRAWN RPK	SHEET 1 OF 1
DATE: MARCH 6, 2018	SURVEYED LDV	